

1 Product 4 applications

Waterproofing, bonding,
de-coupling and
impact sound insulation
weber.xerm 844

**we
care**

All-rounder for indoors and outdoors

Always the right choice for your construction site



weber.xerm 844 –
one product –
four applications –
numerous benefits



Tile layers carry out many operations, for e.g., priming, waterproofing, de-coupling, application of tile adhesives and grout mortars.

For this reason, they must handle and have a wide product range available all the time. Some of the products can be now replaced by a unique solution.

weber.xerm 844 is a highly flexible 2-component system that combines four applications: it can be used as watertight reactive waterproofing under tiles and slabs and at the same time as a high-performance tile adhesive. On top ceramic tiles or slabs can be de-coupled from critical substrates and disturbing foot-fall sound can be reduced.



**Where no water penetrates,
no damage will happen.**

This innovative professional solution saves time and simplifies the working schedule process. Not only less products are needed on stocks, but also the risk with unexperienced to use a wrong product is reduced. Besides this versatility, **weber.xerm 844** has outstanding features, like a fast drying independent from weather conditions. Water cannot penetrate the hardened waterproofing layer; typical moisture damages like efflorescence or spalling due to frost are avoided right from the start.



DID YOU ALREADY KNOW?

The 24 kg package of **weber.xerm 844** is supplied with 4 bags of 3 kg each of component A and B. This ensures an optimum consistency of the application layer, and you only mix the quantity that is required.

Photos 1–2:

1. **weber.sys 835** reinforcing mesh is embedded in the mortar bed of **weber.xerm 844**.
2. Large-format, thin tiles are laid in the buttering-floating method with **weber.xerm 844**.

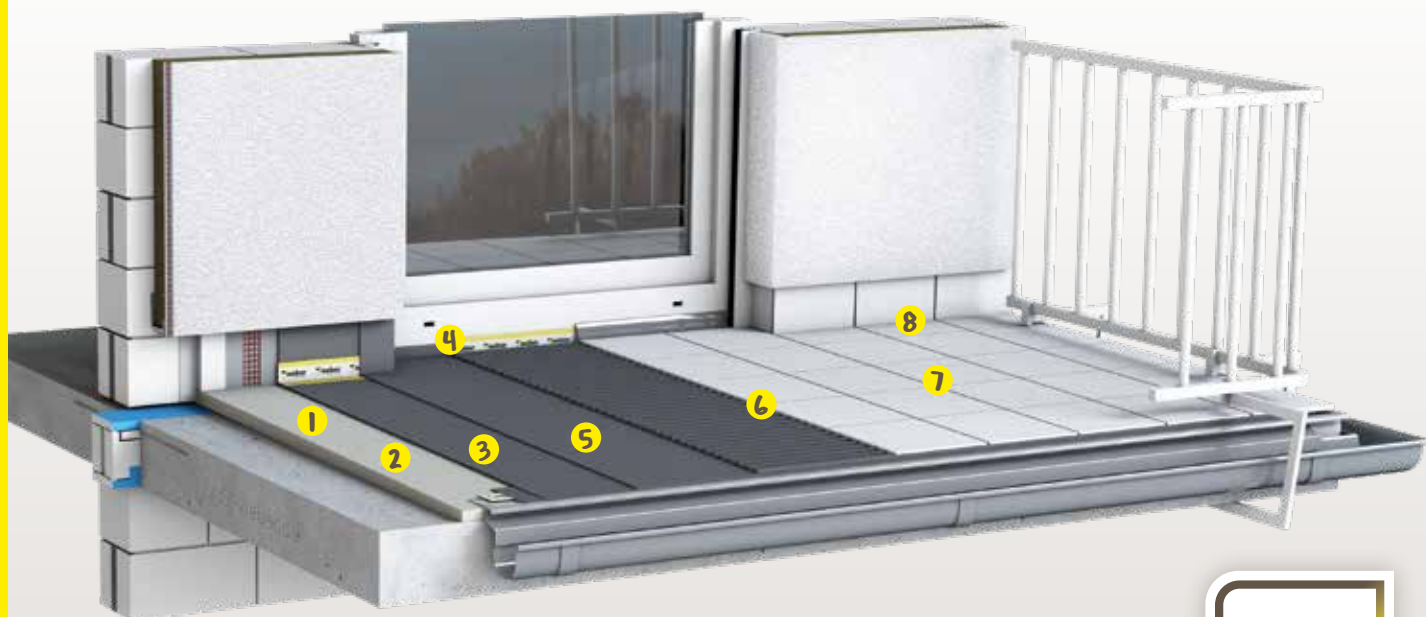

DIN
18531

weber.xerm 844 offers maximum flexibility in application:

waterproofing, tile laying, de-coupling – even slopes corrections can be implemented with the waterproofing system.

Since a chain is only as strong as its weakest link, Saint-Gobain Weber has focused on the laying mortar, especially for this application.

A watertight tile adhesive that can also be used as a waterproofing offers maximum safety as a system and significantly reduces the risk of efflorescence.

The reduction of impact sound is also possible with **weber.xerm 844**. With the innovative trowel, **weber.sys Abdichtungs- und Verlegeglätter**, the waterproofing and application can be applied in a single operation. This saves valuable time.

Recommendation for the construction:

- 1 **weber.plan 816**, screed mortar, fast setting
- 2 **weber.prim 801**, primer
- 3 **weber.xerm 844**, 1st layer waterproofing
- 4 **weber.tec 828**, sealing tape system
- 5 **weber.xerm 844**, 2nd layer waterproofing
- 6 **weber.xerm 844**, 2-comp. waterproofing, de-coupling, and tile adhesive
- 7 **weber.fug 877**, flexible grouting mortar
- 8 **weber.fug 880**, silicone

* DIN 18531 Waterproofing of roofs, balconies and walkways

Weber waterproofing and tile laying systems

Durable structures for balconies and terraces

Innovative application with special trowel, weber.sys Abdicht- und Verlegeglätter

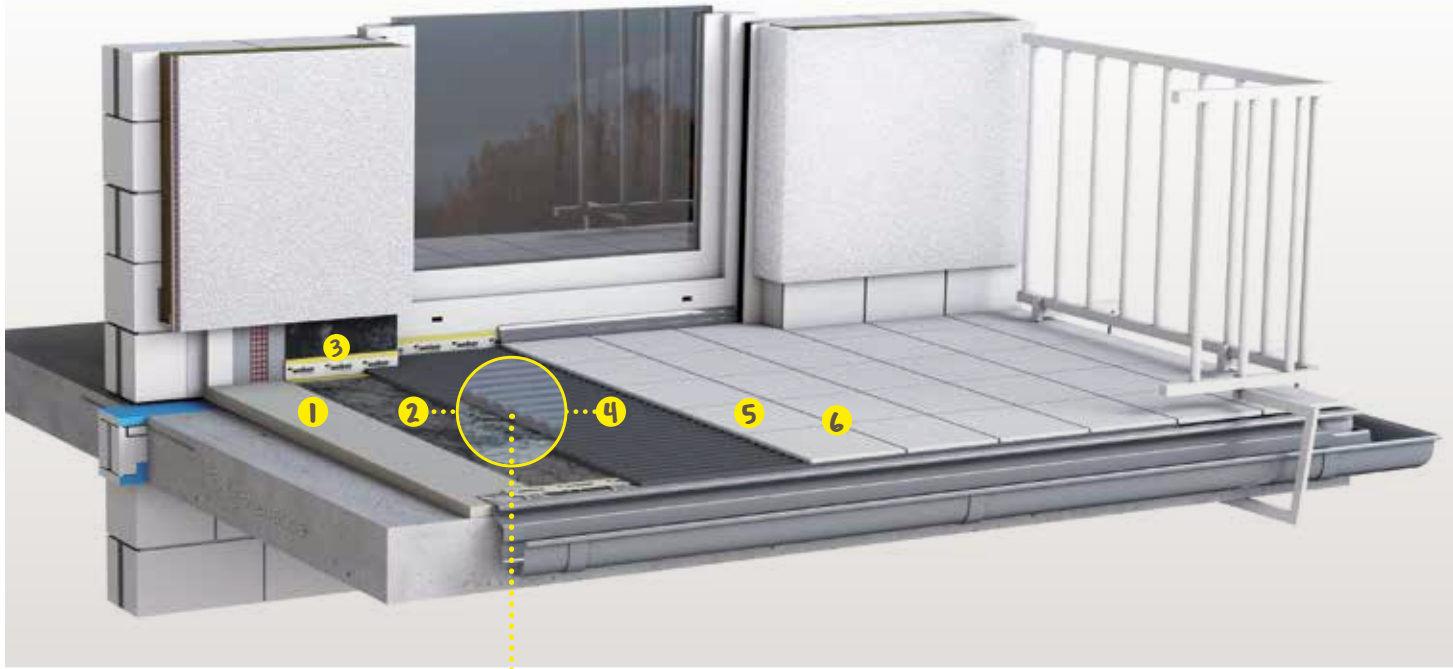

Recommendation for the construction:

- 1** **weber.plan 816**,
screed mortar, fast setting
- 2** **weber.xerm 844**,
scratch layer
- 3** **weber.tec 828**,
sealing tape system
- 4** **weber.xerm 844**,
waterproofing layer and tile
adhesive
- 5** Ceramic tiles (e.g., 60 x 60
porcelain tiles, upon approval
100 x 100 cm)
- 6** **weber.fug 877**,
flexible grouting mortar

For each weather

For a reliable planning with the right system



After 4 hours
the fresh fixed covering
withstands all weather
conditions ...

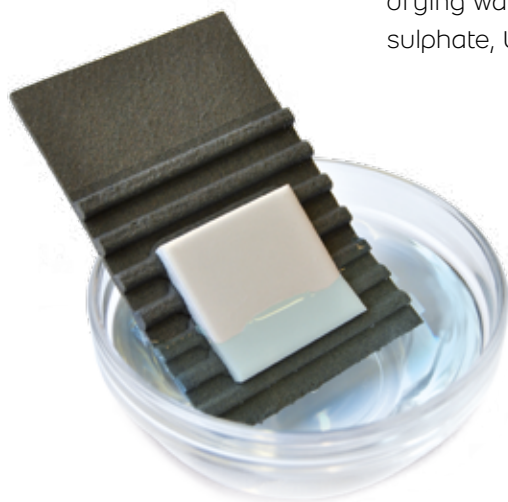

weber.xerm 844 is suitable for solid-bonded waterproofing under ceramic tiles and slabs in bathrooms, wet-duty rooms, balconies, and swimming pools*. It quickly dries also under air exclusion and is after drying watertight resistant to frost, sulphate, UV-rays, and ageing.

The weather cannot be planned ... the right system can!

Due to the reactive hardening and the frost resistance the product ideally suits the tile laying on balconies and terraces. Even in case of large size tiles its drying process is so far ahead after 4 hours that a temperature fall in the night or a heavy rain cannot damage the applied material.

Hence the planning schedule of tile layers is more flexible, since it is nearly independent from weather conditions, especially for outdoor works.

* According to German standard DIN 18534, water loads W0-I up to W3-I for indoor areas, and DIN 18531-5 for outdoor areas



It follows that **weber.xerm 844** with **weber.sys Abdicht- and Verlegeglätter** on the waterproofed surface. The material dries as waterproofing as well as tile adhesive without cracks and free of internal tensions.

Thanks to its quick and weather-independent hardening, and its creamy consistency **weber.xerm 844** offers highest reliability against humidity damages in case of building parts subject to high water load.

Your benefits

-  highly flexible and watertight
-  weather-independent, and quick drying through reactive setting, even under air exclusion
-  avoids efflorescence and frost damages
-  optimal for balconies, terraces, and critical substrates
-  after 4 hours tiles can be grouted
-  also, for large-size porcelain tiles

Photos 1 – 2:

1. **weber.xerm 844** is watertight and offers maximum safety against moisture damages
2. Laying of tiles on a balcony with **weber.xerm 844**

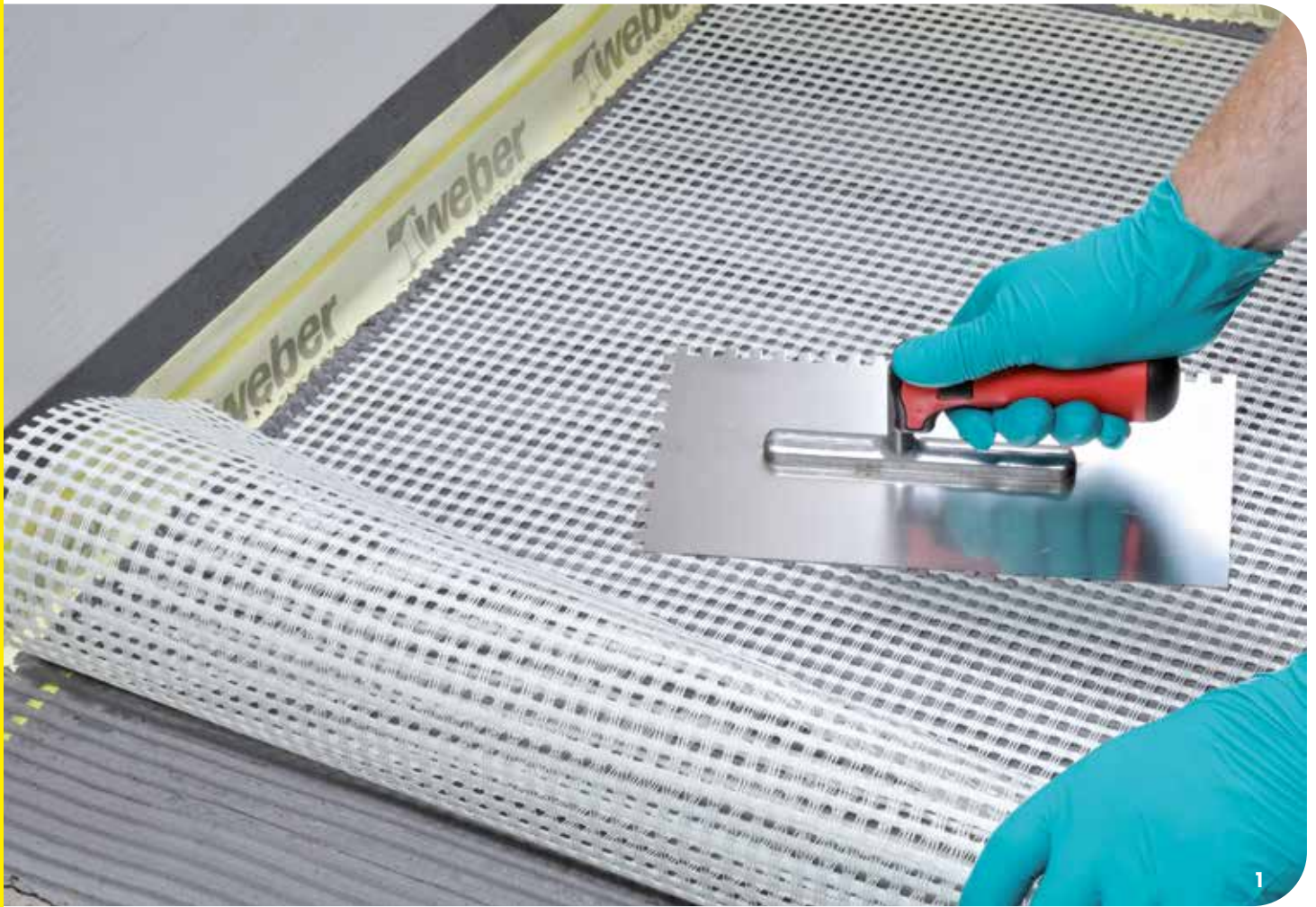

**weber.xerm 844 –
one product –
four applications –
numerous benefits**

weber.xerm 844 can much more. A professional tile layer can de-couple tiles and slabs and at the same time reduce the footfall sound on floors.

He can perform this de-coupling layer by himself whereas he lays the mesh **weber.sys 835**.

The de-coupling is also possible on critical substrates, like young cement screeds etc.; in that case tiles can be laid in the time between 3rd and 7th day after screed application.

A further benefit: due to the full surface embedment of the mesh within the tile adhesive layer hollow sounds like de-coupling membranes will be excluded.

More performance and versatility

Acoustic and de-coupling layer made by yourselves

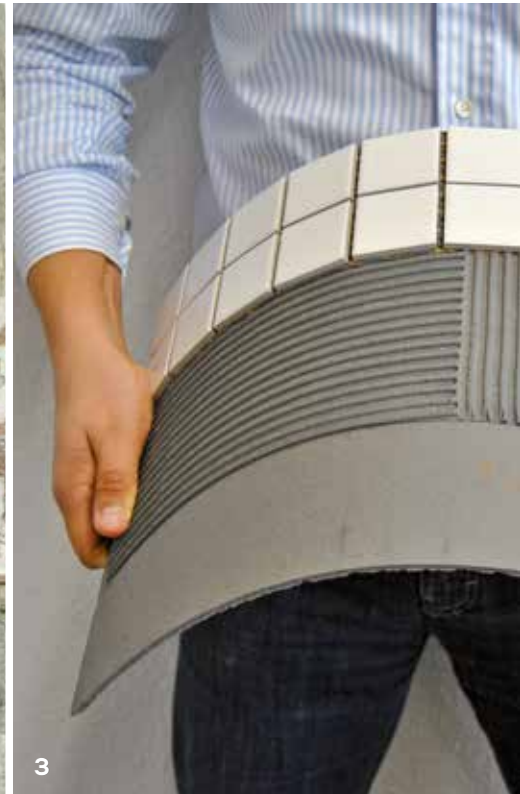

De-coupling with weber.xerm 844 means

- floor coverings are de-coupled with minimal height (1 mm)
- moisture-sensitive substrates are protected from humidity
- an optimal use for critical substrates like young cement screeds, concrete, timber, or mixed substrates is given
- footfall sound absorption is reduced (up to 7 dB)
- a reliable crack-bridging
- shear stresses minimize due to high shear force absorption
- traffic loads are compensated
- hollow sounds like de-coupling membranes in rolls are excluded

Photos 1–3:

1. Extremely thin and withstanding solid-bonded waterproofing
2. On mixed substrates the system enables a reliable tile fixing
3. Extremely flexible system

Tailor-made system solutions

For simple and safe application



Simply safe:
Optimally coordinated
product range.



Cracks in tile or natural stone coverings are often caused by changes in the shape of the substrate. Substrates made of concrete or screed, e.g., „shrink“ during the setting process, as do floating screeds and heated screeds. Therefore, materials that change relatively strongly in comparison to the „rigid tile“ in the case of moisture or temperature alterations are to be regarded as critical.

These include mixed substrates and wooden substrates made of chipboard or hardboard, but also young cement or anhydrite screeds. Depending on the requirements and the degree of optimization, de-coupling according to the Simple & Safe principle can be realized with **weber.xerm 844** in the individual performance levels:

PERFORMANCE LEVEL 1

Critical substrate

For e.g., anhydrite screeds, concrete (> 28 days), young cement screeds (3 – 7 days old), old tiles

Primer

weber.prim 801, **weber.prim 803** or **weber.prim 804** (depending upon substrate)

1 mm de-coupling layer with **weber.xerm 844**

- Solid-bonded waterproofing 1.5 bar
- Crack-bridging 1 mm
- Resistance to mechanical load 75 KN/m²

Tile fixing with **weber.xerm 844**

Improvement of acoustic insulation: up to 7 dB
(flexible tile adhesive of class S1 without acoustic improvement)

Ceramic tiles, porcelain stoneware, or natural stones

Grout mortar

weber.fug 875 F, **weber.fug 875 BlueComfort** or **weber.fug 877**



PERFORMANCE LEVEL 2

Critical substrate

- Mixed substrates, wooden substrates (chipboards or OSB boards), timber plankings
- Mixed substrates with old setting or tension cracks or substrates covered with composite-materials and hence different thermal expansion coefficient

Primer

weber.prim 801 or **weber.prim 803** (depending upon substrate)

1 mm de-coupling layer with **weber.xerm 844** and **weber.sys 835**

- Solid-bonded waterproofing 1.5 bar
- Crack-bridging > 1 mm
- Resistance to mechanical load: 75 KN/m²

Tile fixing with **weber.xerm 844**

Improvement of acoustic insulation up to 7 dB
(flexible tile adhesive of class S1 without acoustic improvement)

Ceramic tiles, porcelain stoneware, or natural stones

Grout mortar

weber.fug 875 F, **weber.fug 875 BlueComfort** or **weber.fug 877**

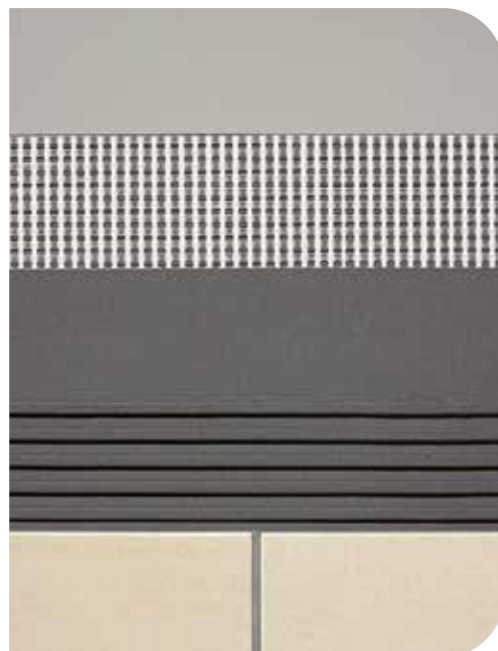

PERFORMANCE LEVEL 3

Critical substrate

Substrates like levels 1 and 2, but with request for a supplementary floor acoustic insulation

Primer

weber.prim 801, **weber.prim 803** or **weber.prim 804** (depending upon substrate)

Glue for fixing acoustic boards with for e.g., **weber.xerm 844**

weber.sys 830 (acoustic and de-coupling boards)

- Improvement of acoustic insulation up to 14 dB (depending on fixation)
- Waterproofing performance 1.5 bar
- Crack-bridging >1 mm

Tile fixing with **weber.xerm 844**

Use of S1 flexible tile adhesive depending on size

Ceramic tiles, porcelain stoneware, or natural stones

Grout mortar

weber.fug 875 F, **weber.fug 875 BlueComfort** or **weber.fug 877**



At **weber**, we believe that the **most important** in the building industry is **to care about people** and **their environment**

Well-being

We care
For the well-being
of people.

**we
care**

Empathy

We care
about what matters
to people.

Long-lasting

We care
about our long-term
responsibility.

